

Calmark offers the Series 107-73 Card Inserter-Extractor for safe and efficient insertion and extraction of PC cards in applications of high insertion and extraction forces. The Series 107-73 offers maximum strength aluminum material. In addition, a "positive locking" feature protects against PC card walkout.

### FEATURES:

- "Ultra strong/extra leverage" design overcomes insertion and extraction forces of the highest limits.
- "Positive" locking feature provides PC board walkout resistance of 200 lbs. minimum.
- Manufactured from high strength aluminum alloy.
- Actuates from a simple "U" channel form.
- Available with CONDUCTIVE finish.
- Available in colors for coding.



### MATERIALS & FINISH

Extractor & Latch - Aluminum alloy 6061-T6.  
Black Anodize per MIL-A-8625, Type II, Class 2.

For Conductive Finish, add prefix "C" to part number (C107-73).  
Clear chemical film per MIL-5541, Class 3.

Latch Spring and Pin - Stainless steel, Passivated.

Roll Pins: Stainless Steel, 3/32" (2.38) Dia x 1/4" (6.4) long.  
Two furnished with each Inserter - Extractor.

For Pre-Started Assembly Pin, add prefix "P" to part number (P107-73)

TOLERANCES: .xxx = +/- .010, .xx = +/- .02

### APPLICATION DATA:

Two inserter-extractors are recommended per card.  
Provides insertion and extraction travel of .35 (8.9) minium  
with a mechanical advantage of approx. 4.2 : 1.  
In locked position, a single device provides  
100 lbs. (445N) minimum card walkout resistance.

### TABULATION

| PART NO. | BOARD THICKNESS |
|----------|-----------------|
| 107-73   | 1/16"           |
| 107-73-3 | 3/32"           |
| 107-73-4 | 1/8"            |

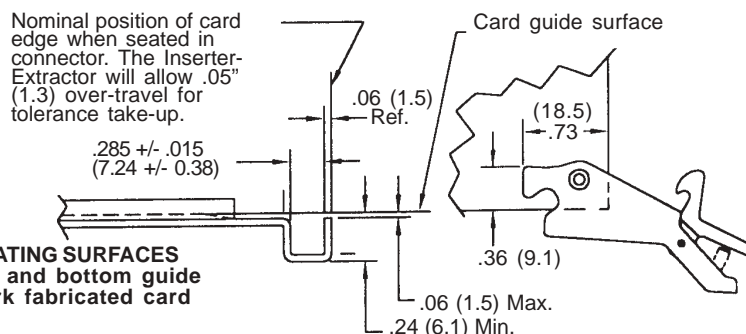
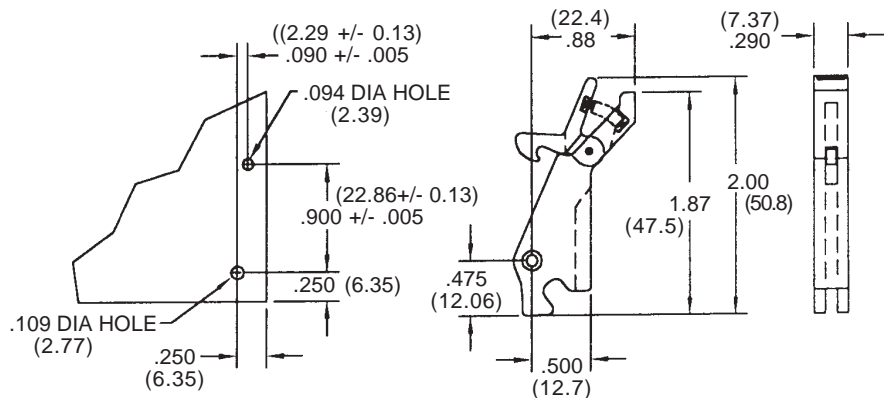

**DETAIL OF ACTUATING SURFACES**  
Required on top and bottom guide plates of Calmark fabricated card cages.