

Calmark offers the Series 107-35 Card Inserter-Extractor for safe and efficient insertion and extraction of PC cards in applications of high insertion and extraction forces. The Series 107-35 offers maximum strength aluminum material. The Series 107-35 is an exact retrofit to the Calmark Series 107-30 molded plastic inserter-extractor.

**FEATURES:**

- **Strong lever action design overcomes insertion and extraction forces in excess of 100 lbs.**
- **Manufactured from high strength aluminum alloy.**
- **Retrofits Calmark Series 107-30 inserter-extractor**
- **Actuates from a simple "U" channel form.**
- **Available with CONDUCTIVE finish.**
- **Available in colors for coding.**
- **Generous area for identification marking.**



**MATERIALS & FINISH**

**Extractor** - Aluminum alloy 6061-T6.  
Black Anodize per MIL-A-8625, Type II, Class 2.

*For Conductive Finish, add prefix "C" to part number (C107-35).  
Clear chemical film per MIL-5541, Cl 3.*

**Roll Pin:** Stainless Steel (3/32" (2.38) dia. x 5/16" (7.9) long).  
Furnished with each inserter-extractor.

*For Pre-Started Assembly Pin, add prefix "P" to part number (P107-35)*

**TOLERANCES:** .xxx = +/- .010, .xx = +/- .02

**APPLICATION DATA:**

Two inserter-extractors are recommended per board.  
Provides insertion and extraction travel of .30 (7.6) minimum with a mechanical advantage of approximately 5.5 : 1.

**TABULATION**

PART NO.	BOARD THICKNESS
107-35	1/16" (1.6)
107-35-3	3/32" (2.4)
107-35-4	1/8" (3.2)

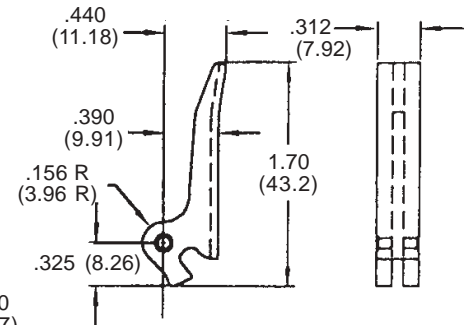
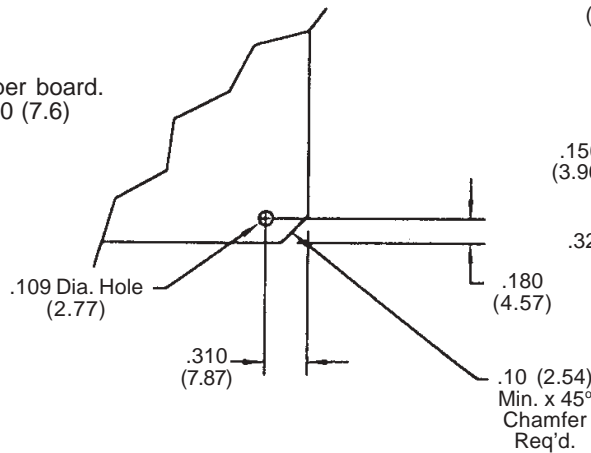

Nominal position of card edge when seated in connector. The inserter-extractor will allow .03 (0.76) over-travel for tolerance take-up.

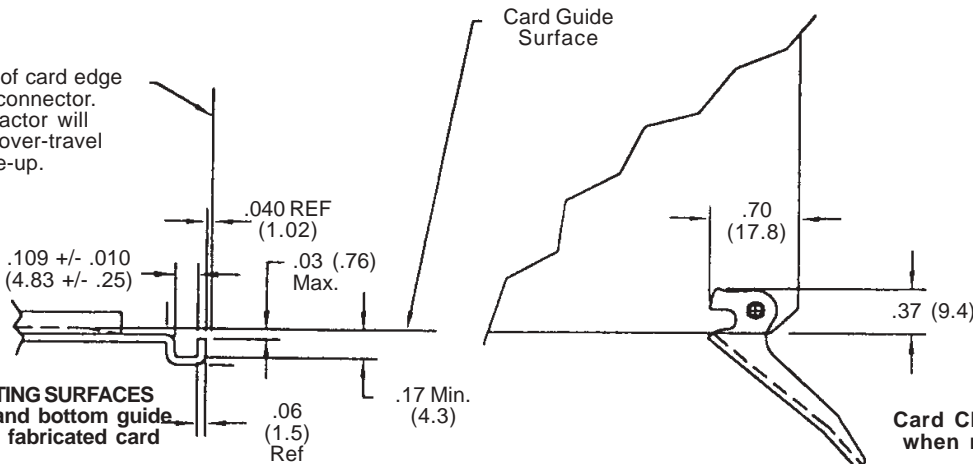

**DETAIL OF ACTUATING SURFACES**  
Required on top and bottom guide plates of Calmark fabricated card cages.

**Card Clearance required when rotated.**